



# MEI **GRYPHON**<sup>TM</sup>

The next generation  
of coin validation



# GRYPHON™ COIN CHANGER

## Configuration and Options

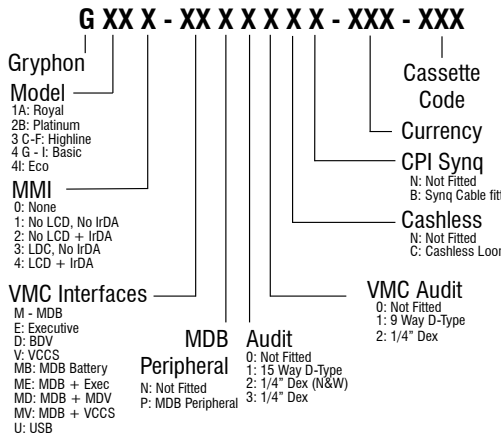

### Six Coin Tubes

Six Coin Tubes means 12% higher capacity and more customer specific cassette configurations

### Simple Interface

Clear and intuitive screen gives status updates and shortens service calls

### USB Audits

Precise vendor monitoring with plug-and-play USB Audits

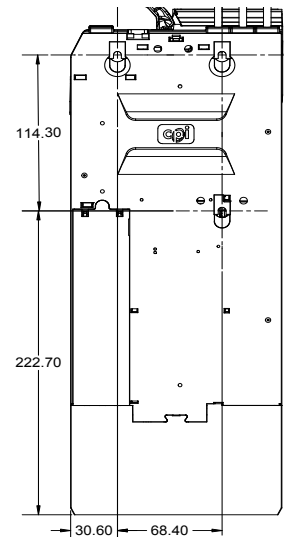
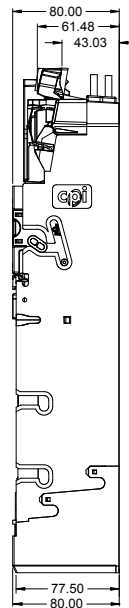
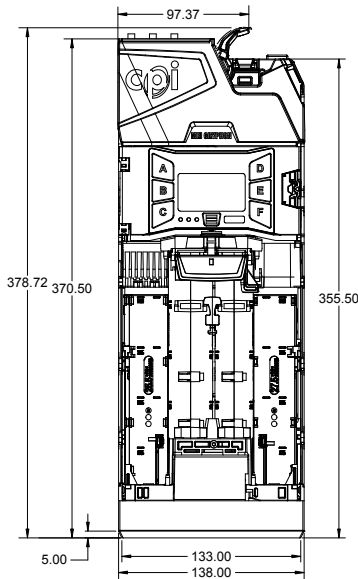

## Specifications

### Acceptance Rate

95% or greater for all coins at nominal conditions

### Transaction Speed

Acceptance: Two coins per second  
 Dispense: Up to six coins per second

### Connectivity

USB, IrDA\*, DDCMP\*, DEX\*, Bluetooth\*

### Environment

- Operating Temperature: -15C to 60C
- Storage Temperature: -40C to 70C
- Humidity: 5% to 95% relative humidity (non-condensing), maximum relative humidity of 50% at extreme temperatures.

### Power Requirements

34 VDC MDB, 24AC BDV & EXEC, 24VDC

### Interfaces

Serial: MDB, MDB & EXEC, MDB & BDV, JVI/VCCI, USB, EXEC

### Shipping Weight

Five Pounds

### Support Tools

STS Advance Software, CPI Synq

### Power Consumption (?)

- Standby: 5 Watts
- Acceptance: 10 Watts

### Coin Diameter

15mm - 33mm

\*Optional